



**9 Lovejoy Lane, Windsor, Berkshire, SL4 4ND**  
**Offers in excess of £255,000**

 **HORLER**

## 9 Lovejoy Lane, Windsor, Berkshire, SL4 4ND

This beautifully presented two-bedroom second-floor apartment with NO ONWARD CHAIN has been recently refurbished to a high standard, offering bright, spacious and contemporary accommodation throughout. Perfectly suited to first-time buyers, investors or those looking to downsize, the property combines modern interiors with a practical and well-designed layout.

The accommodation comprises a generous lounge, a stylish fitted kitchen, two well-proportioned double bedrooms, a modern family bathroom and a separate WC. A particularly appealing feature is the spacious entrance hallway, which provides an abundance of built-in storage, adding to the apartment's everyday practicality.

Further benefits include well-maintained communal gardens, off-road residents' parking and a convenient location close to local amenities and excellent transport links.

This is an excellent opportunity to acquire a move-in-ready home that has been thoughtfully updated throughout. Early viewing is highly recommended.



### **Entrance**

Enter through a communal front door with entry phone system and stairs rising to the second floor.

### **Hallway / study area**

Wood effect laminate flooring and power points.

### **Living room**

With two side aspect UPVC double glazed windows, radiator, power points and wood effect laminate flooring.

### **Kitchen**

A range of eye and base level units with a complimentary work top, inset sink and drainer, a side aspect UPVC double glazed window, appliance space for a washing machine, dishwasher and fridge freezer. Integrated hob, oven and extractor fan, a wall mounted boiler, power points, tiled walls and flooring.

### **Master bedroom**

A double bedroom with a rear aspect UPVC double glazed window, radiator, power points and space for freestanding furniture.

### **Bedroom two**

A double bedroom with a rear aspect UPVC double glazed window, radiator, power points and space for freestanding furniture.

### **Bathroom**

A fully tiled bathroom with a front aspect UPVC frosted double glazed window, panel enclosed bath with shower attachments and shower screen, a pedestal wash hand basin and heated towel rail.

### **Separate WC**

A front aspect frosted UPVC double glazed window, low level WC and a wall mounted sink.

### **Lease information**

Lease: 89

Service charge: To be confirmed

Ground rent: £10 approx

### **Legal note**

\*\*Although these particulars are thought to be materially correct, their accuracy cannot be guaranteed and they do not form part of any contract.\*\*





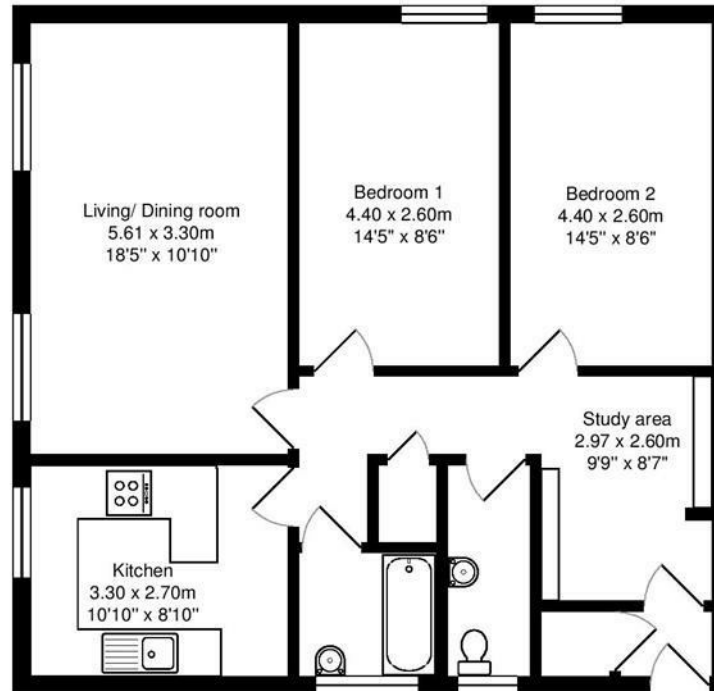

All measurements are approximate and for display purposes only.

Total approx floor area 750 sq. ft (69.7 sq.m)